

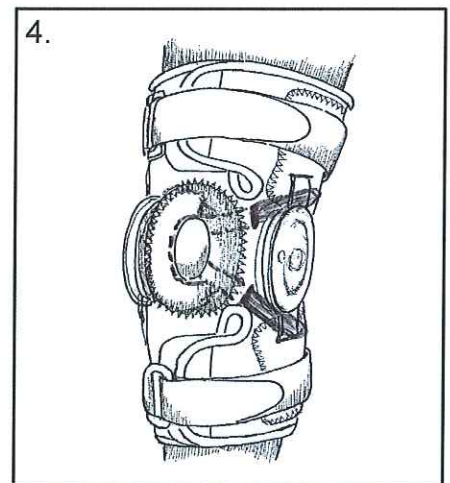

KC44-NOS

Directions for Use

1. Center support in front of leg and pull straight up so that knee cap is centered in opening
2. Secure proximal and distal anterior Velcro closures
3. Thread straps through D-rings and secure
4. Secure patella stabilizing straps to brace.

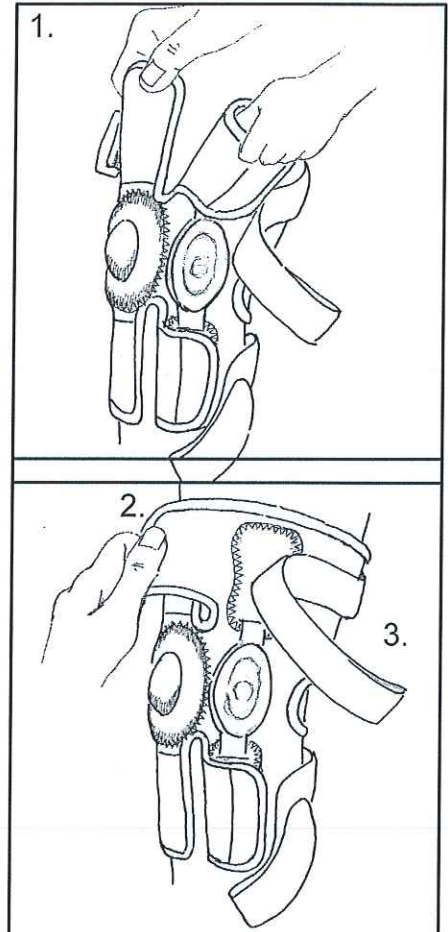

Washing Instructions:

Close all hook and loop closures. Remove hinges from pockets. Hand wash in cold water with mild detergent. NO chlorine bleach. Air dry. Do NOT put in dryer.

SIZE	KNEE CIRCUMFERENCE	6" ABOVE KNEE
XSMALL	12" - 13"	16" - 19"
SMALL	13" - 14"	17" - 20"
MEDIUM	14" - 15"	18" - 21"
LARGE	15" - 16"	19" - 22"
XLARGE	16" - 18"	20" - 24"
2XLARGE	18" - 20"	22" - 26"
3XLARGE	20" - 22"	24" - 28"
4XLARGE	22" - 24"	26" - 30"
CUSTOM	24" & UP - PLEASE PROVIDE MEASUREMENTS	

New Options Sports, 1850 Diplomat Drive #100, Farmers Branch, TX 75234

PH: 800.872.5488 FX: 800.455.5488

www.newoptionssports.com, info@newoptionssports.com

